

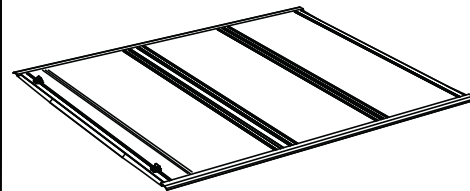

Premium Folding Cover



Fits: TFX3707 - 2019- Current Ford Ranger 5' Bed
TFX3708 - 2019- Current Ford Ranger 6' Bed



30-60 min



Cutting Not Required



Drilling Not Required



THE TRAILFX TONNEAU COMES FULLY ASSEMBLED.



REMOVE CONTENTS FROM BOX. VERIFY ALL PARTS ARE PRESENT.



READ INSTRUCTIONS CAREFULLY BEFORE STARTING INSTALLATION.



DO NOT OVER TORQUE. A TORQUE WRENCH IS NOT NECESSARY. IF PREFERRED, TORQUE IS APX 120 INCH LBS.



support@trailfx.com



1 866 638 4870



LIMITED LIFETIME WARRANTY

KS-R4

PARTS LIST OF COMPONENTS

PN	Part Description/ Qty	PN	Part Description/ Qty
1	Clamp Kit (6)	8	Step Spacers (4)
2	Driver Front Truck Bracket (1)	9	Bulkhead Seal (1)
3	Passenger Front Truck Bracket (1)	10	Pre-Staked Cover Retainer Assemblies (2)
4	Driver Rear Truck Bracket (1)	11	Rubber Spacers 1/4" - (2)
5	Passenger Front Truck Bracket (1)	12	Drain Tubes (2)
6	Front Truck Bracket Mounting Bolts M8 X 1.25 X 20- (2)	13	Foam Pad Bulkhead Seals (2)
7	Rear Truck Bracket Mounting Nuts 1/4 - 20 - (2)	14	Hard Folding Cover (1)/ Left and Right Mounting Rails (1)

Components

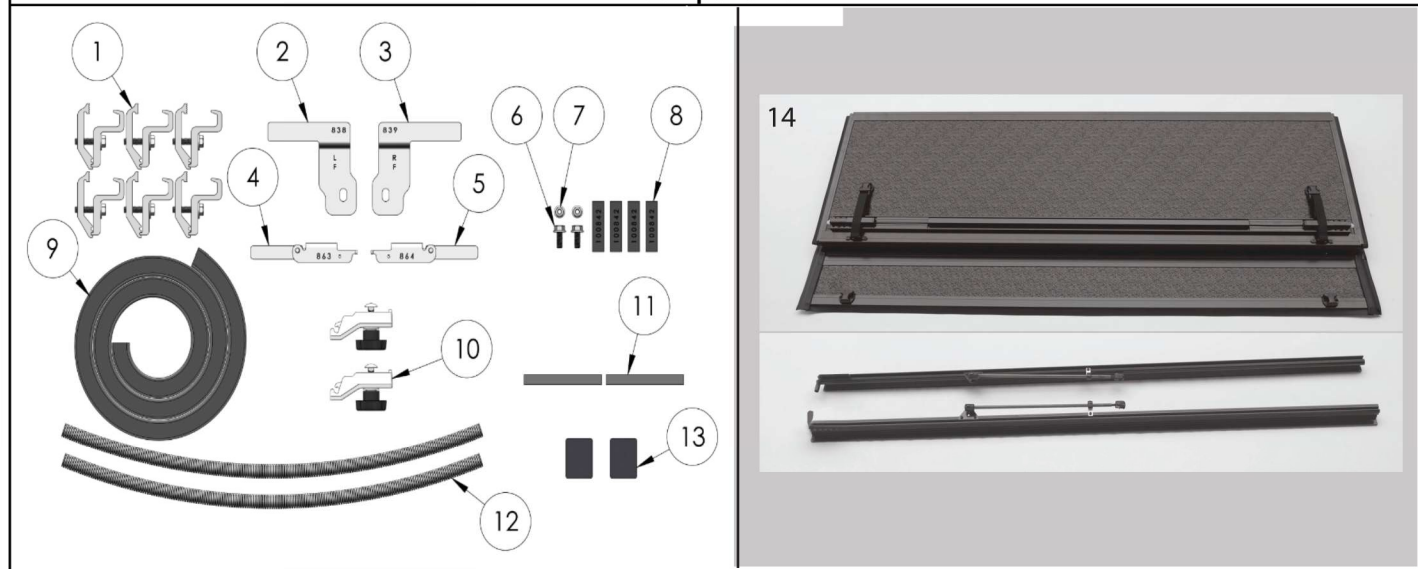

Tools Required

Ratchet & 1/2" Socket



RANGER BULKHEAD SEAL INSTALLATION

NOTE: Install seals before bed cover. The bulkhead seals are installed without any drop-in bed liner in place.

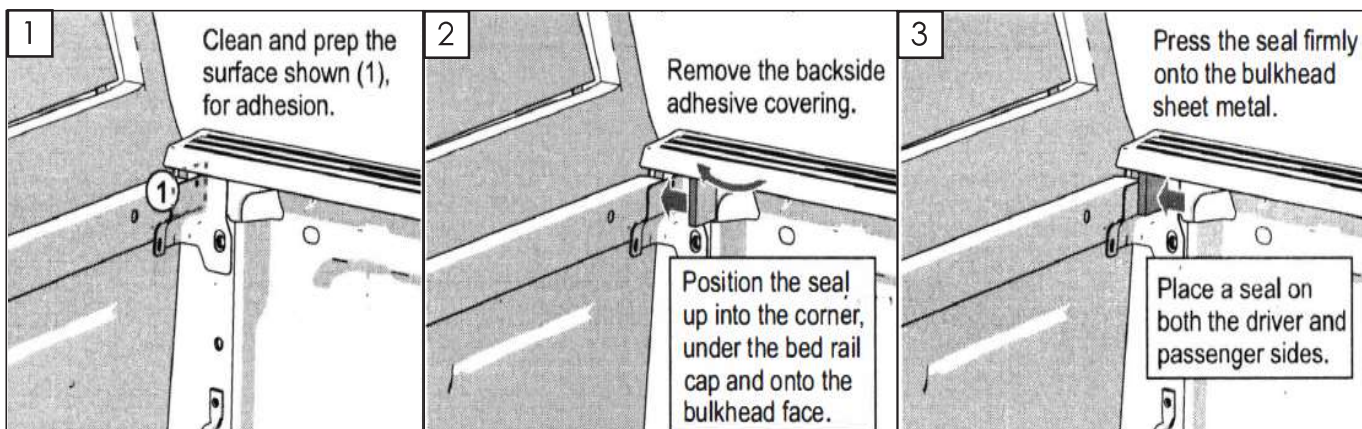

Install the bulkhead weather seal to the truck's front bulkhead.

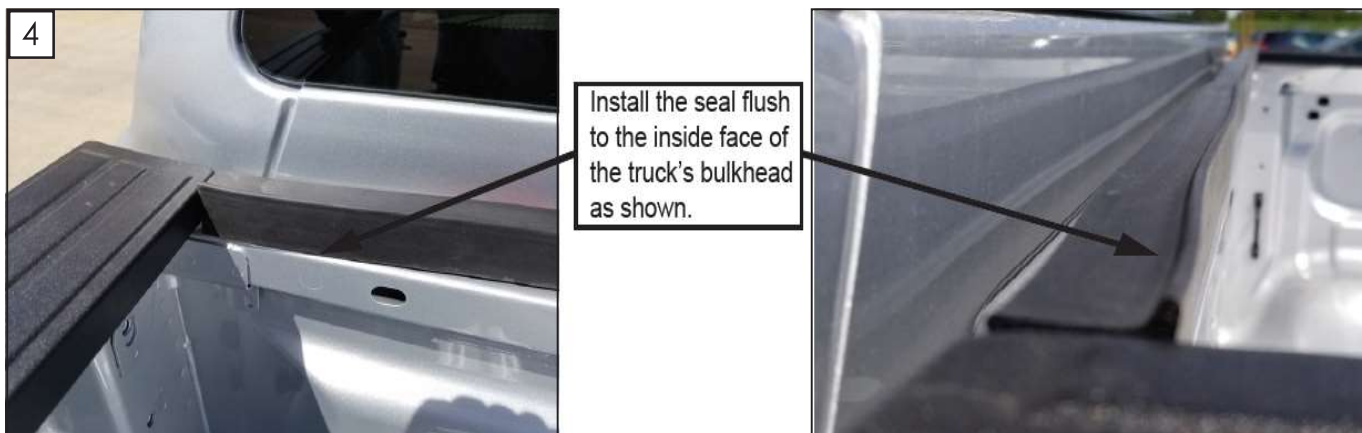

After installing the bulkhead seals proceed to the model specific install guide for mounting the truck specific brackets and cover mounting rails.

Note: Install supplied Bulkhead Seals to the front bulkhead first before installing truck mounting brackets.

Note: If truck is equipped with drop-in bed liner, trimming may be required to install the bulkhead seals and truck brackets (5) supplied in hardware kit.

Drawing 1 Rear Bracket Install: Locate the small hole and slot above the rear tail light post, underneath the bed rail towards the tailgate on either side. Gently lift the edge of the plastic bed rail cap and insert the (Driver (4)/ Passenger (5) rear bracket under the metal bed rail. The locating tab should go into the hole and the 1/4-20 pem stud should slide into the slot opposite the hole (See Diagram). Make sure that the thin, flat portion of the bracket is facing forward and is placed in between the plastic bed cap and metal bed rail lip. Once the bracket is in place, use the 1/4-20 nuts and thread onto the pem studs and tighten using a 7/16" wrench. Careful to not over tighten. Repeat process for other side.

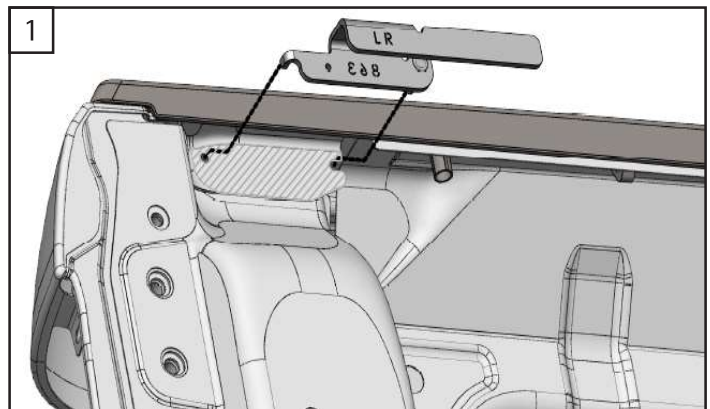

Drawing 2 Step Spacer Install Rear Brackets: Use 2 of the Step Spacers in the hardware kit and place one on either side at the front of the rear bracket (As shown in diagram). Slide the 1/8" portion of the step spacer in between the plastic bed cap and rear truck bracket to fill the gap, flush with the front end of the bracket. The step portion of the spacer should stop against the bottom edge of the plastic bed cap. Repeat process for other side.

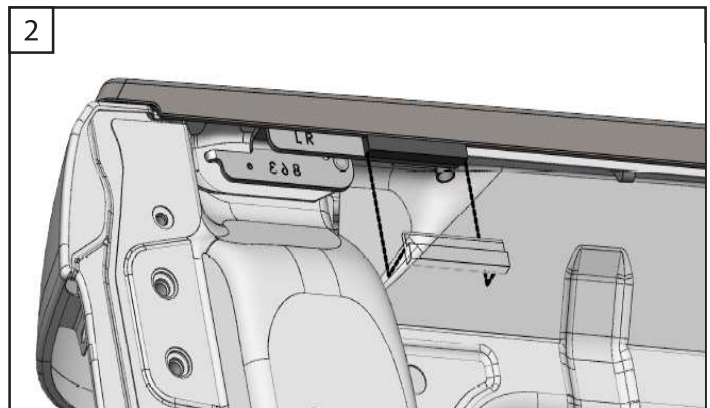

Drawing 3 Front Bracket Install: Locate the Front Truck mounting brackets (Driver (2)/ Passenger (3)). Slide the flat flange portion of the bracket in between the plastic bed cap and metal bed rail lip and move upward until the bracket bottoms out and the slotted hole lines up with the top threaded hole in the front corner, on the side (See Diagram). Using the (M8 X 1.25 X 20 Hex Bolts) and thread into the top threaded hole and tighten using a 13MM wrench. Repeat process for other side. If truck has a spray in bed liner threads may need to be cleaned out first before installing hex bolt.

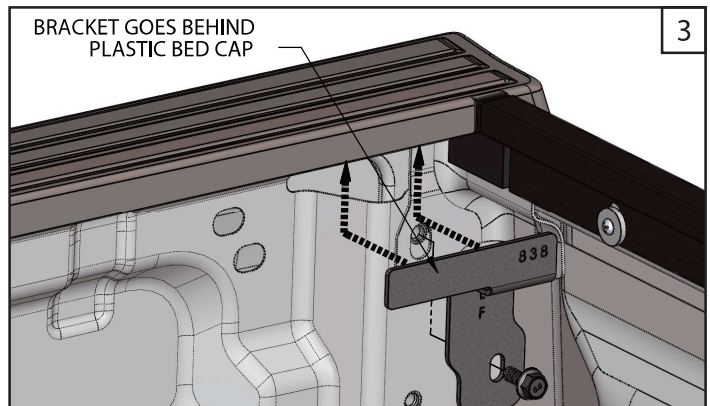

Drawing 4 Step Spacer Install Front Brackets: Use the remaining 2 Step Spacers and place on either side at the rear of the front bracket (As shown in the diagram). Slide the 1/8" portion of the step in between the plastic bed cap and front bracket to fill the gap, flush with the end of the bracket. The step portion of the spacer should stop against the bottom edge of the plastic bed cap. Repeat process for other side.

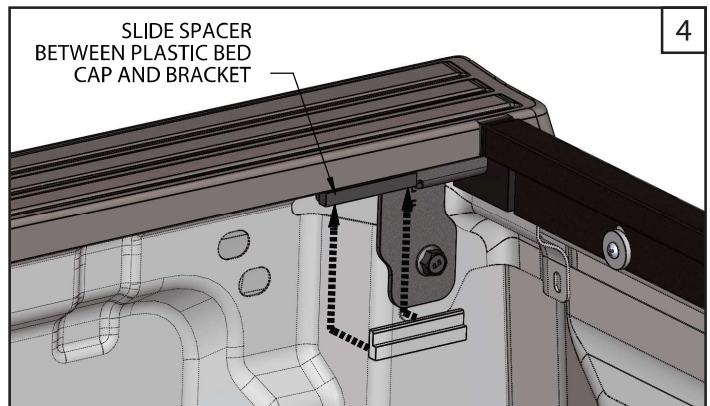

INSTALLATION PROCEDURE

Stick one of the rubber spacers to the bed rail adjacent to the middle clamp rail spacer (black piece with 'clamp' written on it) (Drawing 3), prior to installing the mounting rail. Tip: Lay the cover mounting rail on top of the truck bed rail, drain tube towards the cab, to help indicate position of the filler strips. The filler strips should be mounted on the lower portion of the bed rail. On the front (cab) spacer, two spacers will be used on either side of the metal stamping.

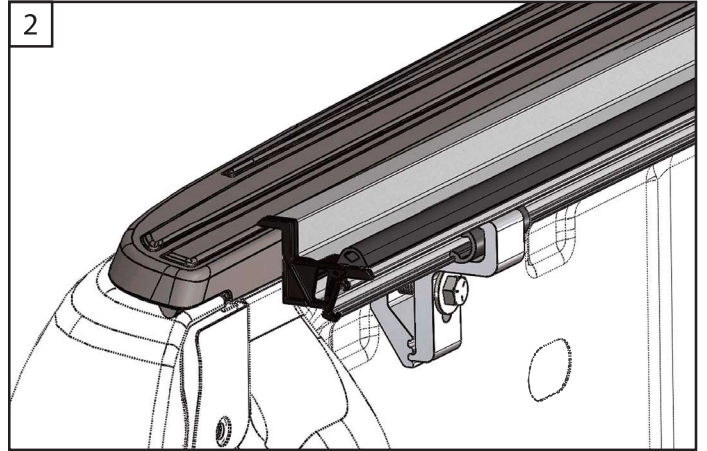
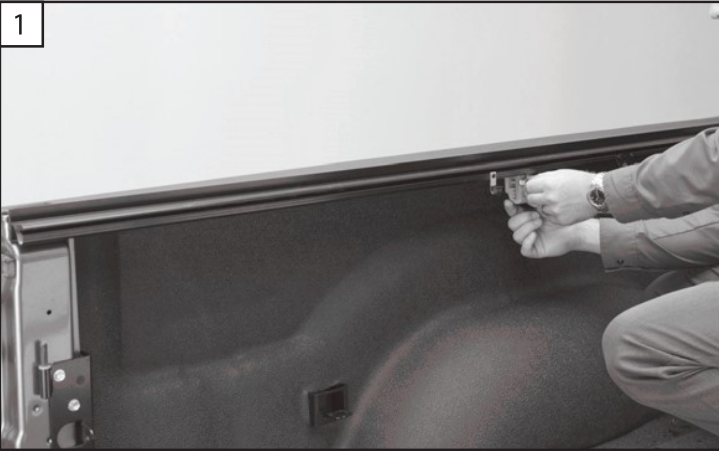

1. Attach both left and right side rails to the truck bed. The end of the mounting rail with the drain tube fitting will go towards the cab of the truck, position flush to bulkhead.

2. Position the top edge horizontal surface flush to bed rail.

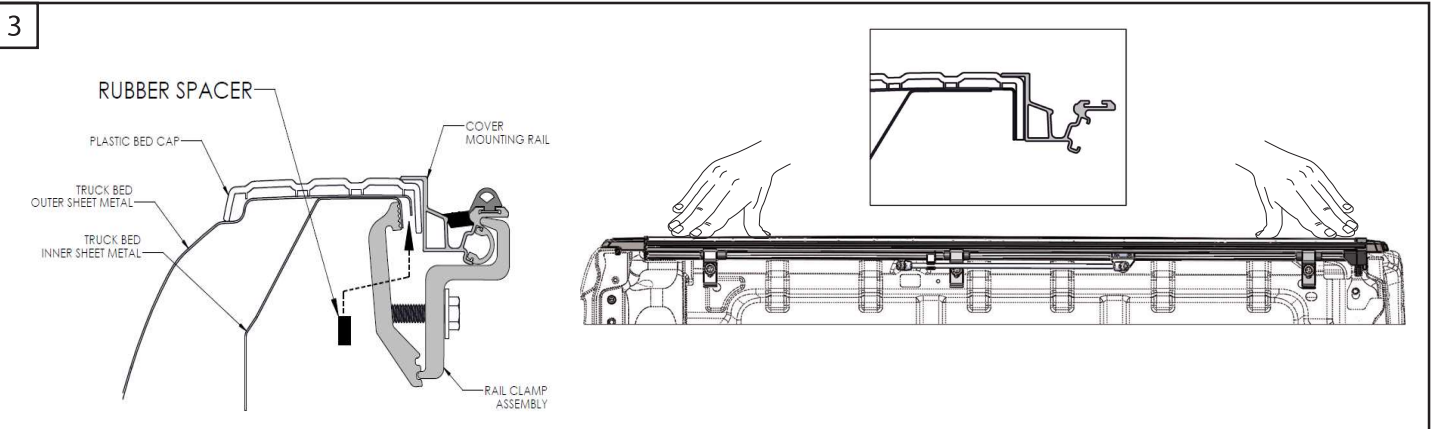

3. Using three (3) clamps per side attach the rail to the bed, position the clamps adjacent to each of the black rail spacers. Apply downward pressure to the rail when tightening each clamp to ensure the rail sets flush and seals properly. A second set of hands may help. Figure 3. (Tip: Mount the center clamp first but do not tighten completely. This will give you the ability to adjust the rail as the outer clamps are attached)

4. Tighten the clamps using a 1/2" socket.

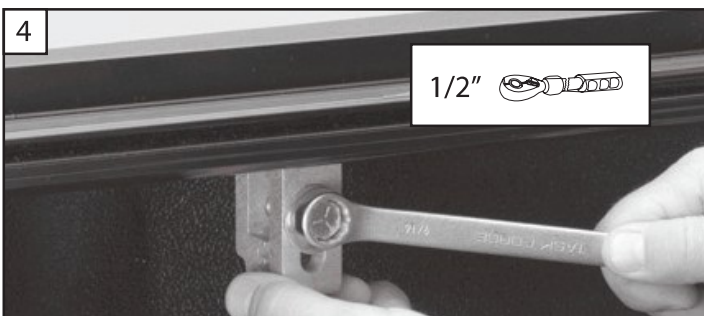

Warning! Do not overtighten the clamp assembly. A torque wrench is not necessary. If preferred, torque is apx 120 inch lbs.



Warning! Clamps must be checked periodically for tightness. Failure to do so could result in damage to you or your property.

5 & 6

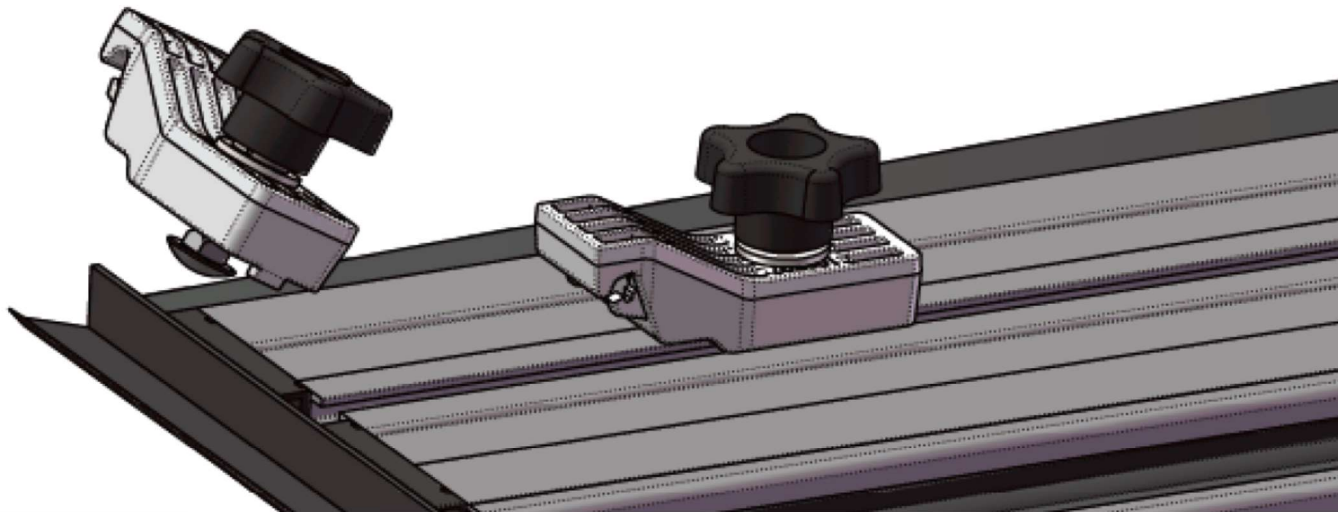

5 & 6. Slide the two front pre-staked cover retainer assemblies into the track on the underside of the tonneau cover, do not remove bolt from assembly.

7



7. Place the tonneau onto the mounting rails with the smallest panel towards the cab of the truck and with the front flap covering the bulkhead.

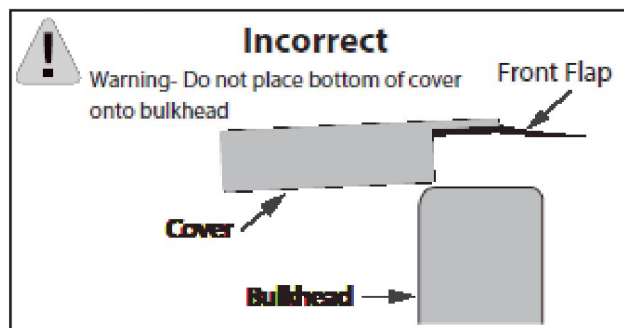
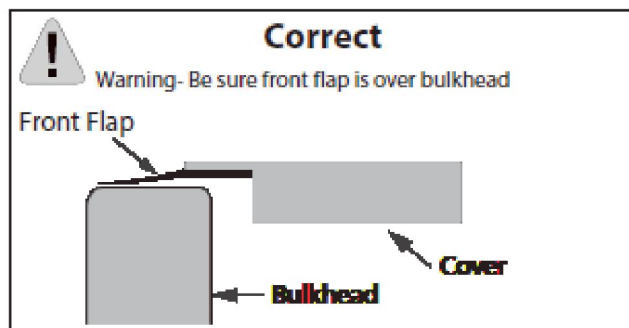



8. Carefully unfold the cover. Position the cover so it is centered side to side and front to back on the truck bed.



9. Test the rear latching assembly for smooth operation as this is the best indicator of the cover being positioned correctly. Be sure the latches on both sides are engaging with the cover mounting rail.



10 & 11. Once the cover is located correctly, fold the cover to the open position. Pull the release cables on the rear panel to release it from the side rail. Take care to fold it gently so the position of the cover is not disturbed.

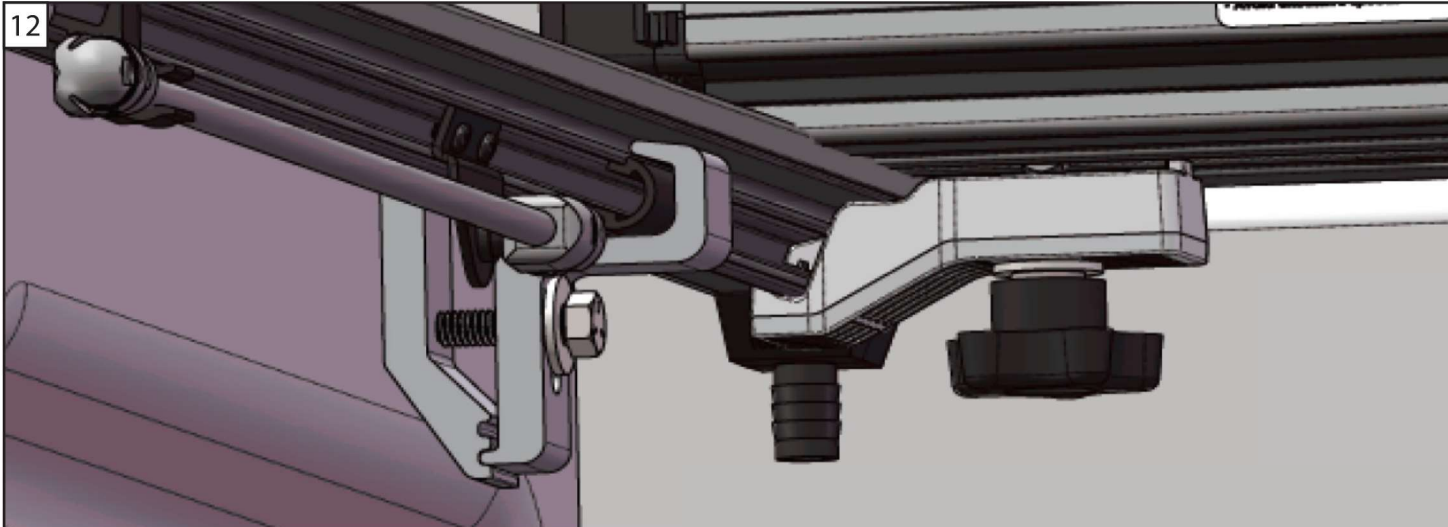

12. Once in the open position place the front pre-staked cover retainer assemblies, (retainer clamp, flat washer, lock washer, star knob and front mounting bolt), underneath the cover and so that the retainer clamp engages into the mounting rail and hand tighten. Be sure the front retainer clamp is clamping to the side rail correctly. Test the cover again for proper operation, adjust as needed, then tighten the star knobs.



13. Attach the prop rod to the side rail.



14. Attach the drain tubes to the fittings at the front of the bed rail and position the tubes to divert water out of the truck bed. This can be done by placing the tube behind a bed liner, through an existing hole in the bed, or by drilling a 5/8" hole in the bulkhead or bed floor.

Note: If you choose to place the tube behind your bed liner, be sure your drain holes in the bed are not clogged.

Note: If you choose to drill holes, check to make sure the area is free and clear of any obstructions below/ behind the bed. Be sure to clean up metal shavings.

OPERATION INSTRUCTIONS



1 & 2. To open the cover: Lower the tailgate and pull the cable. While pulling on the cable lift the panel up and towards the cab, repeat for the next panel.

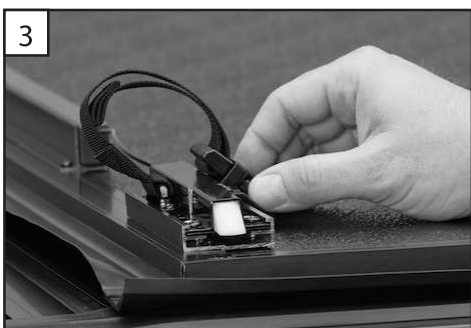

3, 4 & 5. If this is as far as you would like to open the cover, you can secure it in this position. Release the strap from the stowed position by squeezing the tabs. Attach the buckle at the bulkhead, pull the strap to take up the slack and secure the cover. Repeat this for the opposite side.



Warning! Do not lean the cover against cab or damage to the truck and/or cover can occur.

6 & 7. Pull the cable on the third panel and fold the cover up towards the cab.

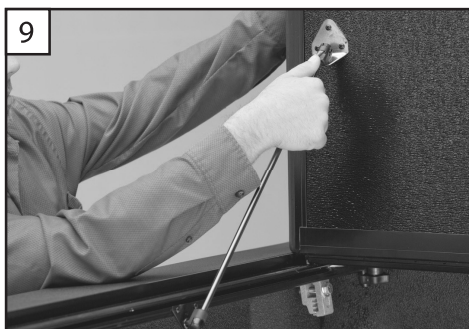
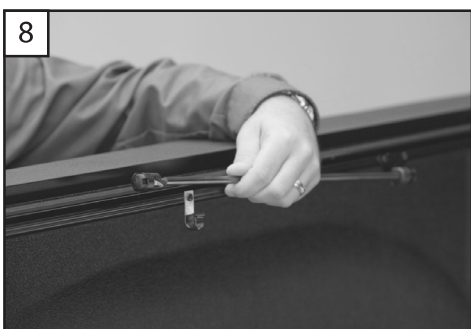

8 & 9. Snap the prop to the mount on the cover, repeat for the other side. To close simply reverse this process.

PRODUCT CARE

- Clean with soap and water only.
- Cover must be secured when vehicle is in motion. See instructions for recommended driving positions. An unsecured cover can result in damage not covered by this warranty.

WARRANTY COVERAGE

Keystone Automotive Operations Inc. (KAO) warrants this product to be free of defects in material and workmanship at the time of purchase by the original retail consumer. KAO disclaims any other warranties, express or implied, including the warranty of fitness for a particular purpose or an intended use. If the product is found to be defective, KAO may replace or repair the product at our option, when the product is returned prepaid, with proof of purchase. Alteration to, improper installation, or misuse of this product voids the warranty. KAO's liability is limited to repair or replacement of products found to be defective, and specifically excludes liability for any incidental or consequential loss or damage. The repaired or replaced tonneau will be in warranty for the remainder of the original warranty period.

FAQ:

1. How difficult is it to install the tonneau cover?

Installing of tonneau cover is easy, please follow the steps in installation manual carefully.

2. How do I clean my tonneau cover?

Wash the tonneau same as your truck. We recommend using soap and water.

3. Will the tonneau cover scratch my paint?

No. Please follow the installation instruction manual carefully to avoid scratching paint.

4. Missing or Excess Hardware?

Re-check hardware count as per the part list.

5. Why is my tonneau cover not installing properly?

Ensure year, make, model, cab length and bed size of your vehicle is listed in the application and installation steps are followed correctly.

CHECK OUT THESE OTHER TRAIL FX PRODUCTS!



SIDE BARS



ROCKER GUARD



BED RAILS



RUNNING BOARDS